

# HINO KAZAY A/C LUXARY BUS

## Chassis Specification

**Model:** RN8J (R.H.D, 4X2) bus chassis  
**GVW :** 16,000 Kgs.

### Engine Details:

**Engine Model:** Hino J08E-UF .  
**Type:** Diesel, turbo charged and intercooled, 4 cycle, 6-cylinder, vertical, in-line, overhead camshaft, water cooled, direct injection type.  
**Max. output:** 260PS @ 2,500 rpm  
**Max. torque:** 76.0 kgf.m @1,500 rpm  
**Displacement:** 7.684 L

### Clutch:

Dry single plate with damper springs, hydraulic control with air booster.  
**Clutch size:** 380 mm

### Service Brake:

Full air, dual circuit, "S" cam type, leading & trailing shoes for front and rear

### Suspension:

**Front & Rear:**  
Air bag suspension with double acting shock absorbers and stabilizers

### Transmission:

Six forward & one reverse speeds, direct drive, synchromesh 2nd ~ 6th, with mechanical control.  
1st - 8.189 & 6th - 1.000  
Rear axle ratio - 4.300

### Steering:

Telescopic and tilt steering column with locking device. Recirculating ball with hydraulic booster, integral type.

### Wheel & Tire:

**Size:** 11.00 R 22.5-16.  
**Wheel Type:** 10-stud disc wheels (ISO type)  
**Disc size:** 22.5 X 8.25  
**No. of tires:** 7 (including one spare tire)

### Dimension Chassis

Wheel base	mm	6,000
Overall length	mm	11,470
Overall width	mm	2,430
Road clearance	mm	230
Turning Radius	mm	9,400
Max Speed	km/hr	127
Gradeability (tan θ)	%	30.70

### Electrical Equipment:

**Batteries:** 02 Nos. series connection, each 12V, 200 AH at 20-hour rate.  
**Alternator:** 24V, 140A



## Body Specification

### Body Super Structure

Principal frame work of hollow square and rectangular M.S tubes for structural strength and passenger safety.

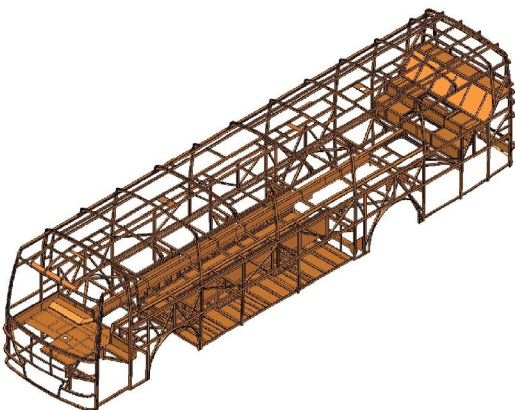

### Door:

01 no. auto door out-swing type.

### Floor:

Ply wood cover with antiskid PVC mat.

### Seats:

45 nos. reclinable seats with individual bottom and back covered with vinyl.



### Interior Fittings:

Fabric curtains, driver & attendant partition, sun visors, first aid box, room lights, video system with 2 LED screens and hatrack on both sides.



### Body Paneling

**Exterior:** M.S sheet

**Front & Rear:** Fiber glass molded panels

**Bumper:** Front & Rear bumper is fiberglass detachable type.

### Windscreen & Windows:

-Front screen of safety laminated curved glass in split type.  
-Rear and side glasses of tinted toughened pasted glass.

### Exterior Fittings:

Underfloor luggage compartments with lockable lids, electrical operated side and under view mirrors. Towing hook & service lids provided for battery, radiator & engine maintenance.

### Air Condition:

Direct drive DENSO air condition.

### Optional items:

- Antiwax Coating.
- Fiber glass wheel caps.

### IMPORTANT.

- The vehicle mass may vary when optional equipment & items are fitted.
- All specifications are with normal manufacturing allowances and tolerances.
- Hinopak Motors Ltd. reserves the right to alter this specification without notice.